

# MOVIEQUIET 26

## OPERATION GUIDE



# MOVIEQUIET 26

## OPERATION GUIDE



<b>Specifications</b>	4
<b>MovieQuiet 26 Overview</b>	5
<b>Safety</b>	6
General Safety Precautions	6
Equipment Damage	6
<b>MovieQuiet 26 Operation</b>	7
Powering on the MovieQuiet 26	7
Charge-only mode	7
Charge/Bypass Mode	8
Inverter Mode	8
Touchscreen Display	9
Settings	9
Powering off the MovieQuiet 26	9
<b>Appendix A - Optimal Operating Conditions</b>	10
<b>Appendix B - Typical Run Times</b>	11

# SPECIFICATIONS



## Model: WV26-WHF-01

The WV26-WHF-01 is a 26kWh capacity portable power pack suitable for use in the entertainment industry, special events, RV, construction, search & rescue and other situations where a quiet reliable AC power source is required. It features a 3R weather-resistant enclosure and is easily transportable with forklift pockets.

## Distribution Panel

- 50A 240VAC twist lock receptacle (x1)
- 30A 120VAC hospital grade twist lock receptacle (x1)
- 20A 120VAC hospital grade receptacle (x2)
- 50A 120VAC Joy connector (x1)
- 5VDC 5A 4 slot USB charger port

## Charge Ports

- Single 50A 240VAC twist lock

## Overall Dimensions

Length	1361 mm / 53.6"
Width	914 mm / 36"
Height	701 mm / 27.6"
Unit Weight	421 Kg / 930 lbs

## Inverter Specs

Nominal AC output voltage	120/240 VAC +5%
Output frequency & accuracy	60 +0.1 Hz
Total harmonic distortion (THD)	< 5%
Continuous power output	8800 Watts @ 40°C
Peak power	17000 Watts (5 seconds)
Peak output current (typical)	35 AAC @ 240VAC
Inverter efficiency	94% at 50% of rated load
Waveform	Pure sine wave, THD <5%
Operating temperature	-20°C to +50°C (-4°F to 149°F)

# MOVIEQUIET 26 OVERVIEW

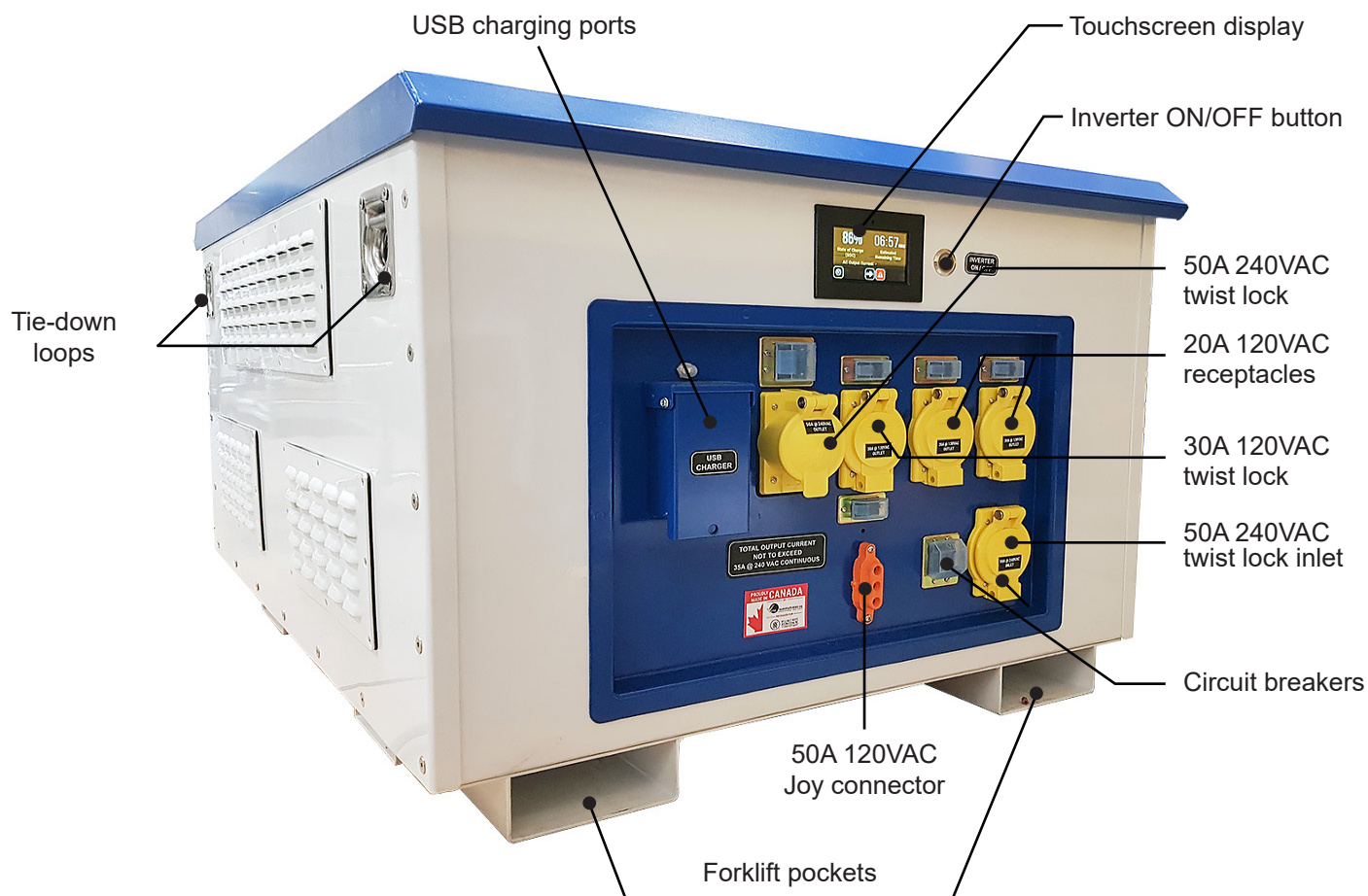

(Other side)

Main breaker

Main ON/OFF buttons



Main disconnect panel - cover

## GENERAL SAFETY PRECAUTIONS

1. Before using the MovieQuiet 26, read this complete manual and cautionary markings on the MovieQuiet 26 enclosure. Be sure to read all instructions and cautionary markings for any equipment attached to this unit.
2. This product is designed for light outdoor installation. Limit exposing the MovieQuiet 26 to rain, snow, spray, bilge or dust. To reduce risk of hazard, do not cover or obstruct the ventilation openings. Do not install the MovieQuiet 26 in a zero-clearance compartment—overheating may result. Allow at least 30cm (11.81 inches) of clearance around the MovieQuiet 26 for air flow. Make sure that the air can circulate freely around the unit. A minimum air flow of 145CFM is required when the unit is used at power output of 80% and above.
3. To avoid a risk of fire and electronic shock make sure that existing wiring is in good electrical condition; and that wire size is not undersized. Do not operate the power pack with damaged or substandard wiring.
4. This equipment contains components which can produce arcs or sparks. To prevent fire or explosion do not install in compartments containing batteries or flammable materials or in locations which require ignition protected equipment. This includes any space containing gasoline-powered machinery, fuel tanks, or joints, fittings, or other connection between components of the fuel system.
5. Do not disassemble the MovieQuiet 26. It contains no user serviceable parts. Attempting to service the MovieQuiet 26 yourself may result in a risk of electrical shock or fire.
6. To reduce the risk of electrical shock, disconnect both input and output AC power from the MovieQuiet 26 before attempting any maintenance or cleaning. Turning off controls will not reduce this risk.

## EQUIPMENT DAMAGE

The output side of the MovieQuiet 26 AC wiring should at no time be connected to public power or a generator. This condition is far worse than a short circuit. If the unit survives this condition, it will shut down until corrections are made.

Installation should ensure that the inverter's AC output is, at no time, connected to its AC input.

### ***WARNING: LIMITATIONS ON USE***

Specifically, please note the MovieQuiet 26 should not be used in connection with life support systems or other medical equipment or devices. We make no warranty or representation in connection with their products for such uses. Using the MovieQuiet 26 with this particular equipment is at your own risk.



# MOVIEQUIET 26 OPERATION



- It is recommended the MovieQuiet 26 be operating on as level as surface as possible.
- Ensure the main disconnect, inverter output and load receptacle breakers are all closed.

## POWERING ON THE MOVIEQUIET 26

1. Ensure main breaker is in the ON position.
2. Press and hold the button labelled ON until the ring illuminates green (15 sec).
3. Release the ON button.

The MovieQuiet 26 has three modes of operation:

- Charge Only Mode
- Charge / Bypass Mode
- Inverter Mode

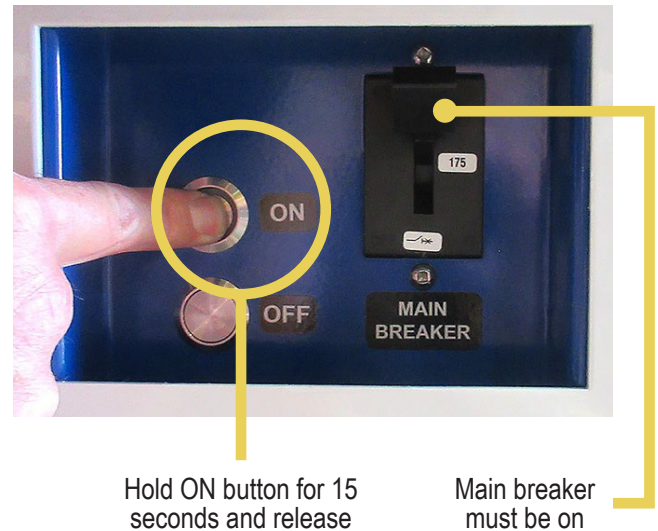

## CHARGE-ONLY MODE

In charge-only mode, no loads are connected to the output side. Charging can occur regardless of the state of the inverter on/off button.

Set the charge current to the maximum allowable for the feeding circuit breaker. The default is 30A. Lower values of 24A and 15A are selectable for the appropriate size feed circuit breaker.

1. To change the charge current setting, use the right arrow button to scroll through the user screens until you reach the charge current setting screen.
2. Press **Charger Input Current**
3. The three options represent the AC current draw of the unit during full charge mode and is the maximum current the unit would draw during charge.
  - a. Select **15A** if your breaker is 15A or less
  - b. Select **24A** if your breaker is between 15 and 30A
  - c. Select **30A** if your breaker is 40A or more

The selected value will be highlighted.

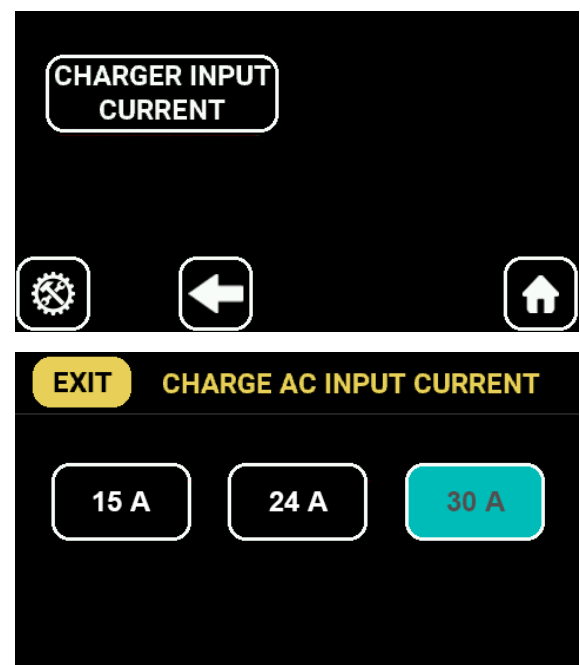

# MOVIEQUIET 26 OPERATION



4. Press **Exit**
5. Return to the home screen, either by pressing the home button in the bottom right corner of the screen, or the left arrow button until you reach the home screen.
6. Insert the 240VAC input power cord into the input receptacle.
7. The charger will automatically start charging the battery as required after a short startup period (20-30 sec).
8. Monitor the touchscreen display to see current state of charge.

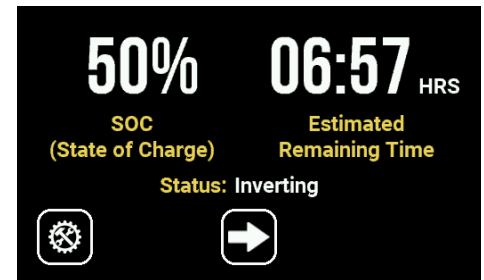

## CHARGE/BYPASS MODE



1. Insert the charging power cord into the input receptacle.
2. Once the unit verifies the supply, the power will be available at the load receptacles (ampacity dependent on inlet used — max 50A).
3. While in Charge / Bypass Mode, batteries will continue to be charged at a reduced rate. Rate is dependent on the output load. The maximum allowable charge and bypass load is 50A at 240VAC.

## INVERTER MODE

1. Turn the inverter on by pressing and releasing the Inverter ON/OFF button beside the display.
2. The LED in the button will illuminate green indicating the inverter is running. The display will also indicate inverting in the status line.
3. If not already done, connect the loads to the load receptacles.
4. Turn off the inverter when the unit is not in use to minimize power consumption and preserve battery charge.

"Inverting" status

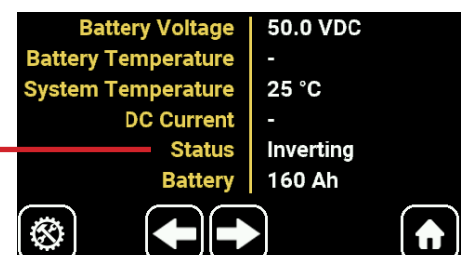



## TOUCHSCREEN DISPLAY

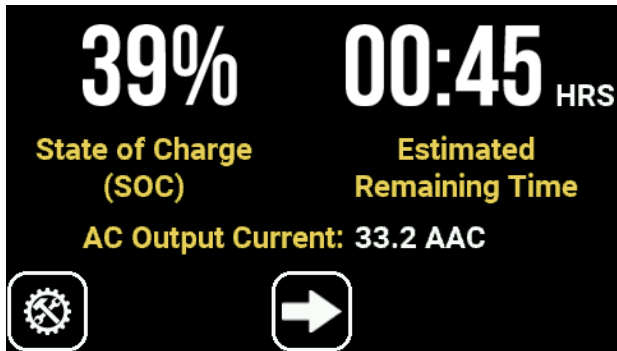

Home screen

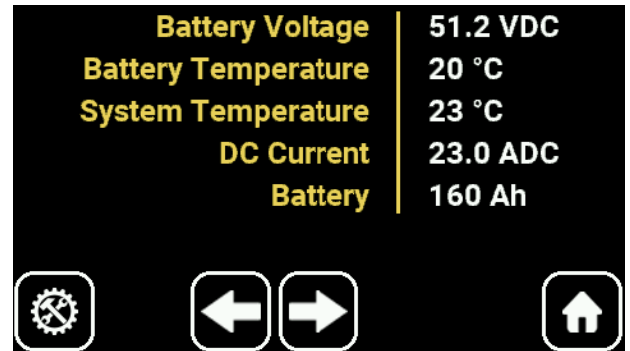

Second info screen (press right arrow on home screen)

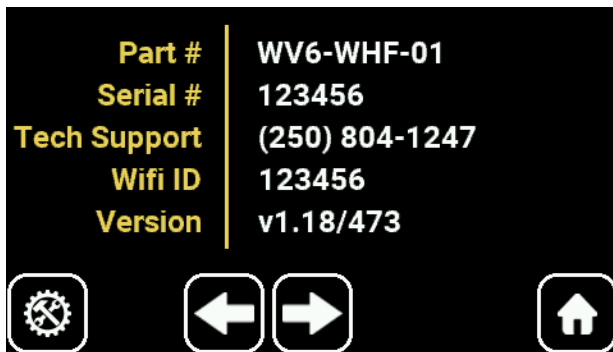

Third info screen  
(press right arrow on second info screen)

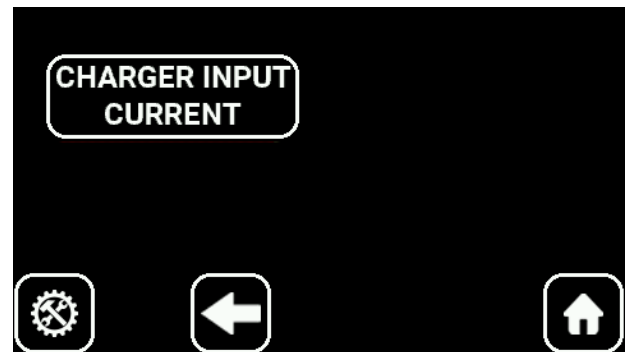

Charger Input Current screen  
(press right arrow on third info screen)

## SETTINGS



The Settings screen provides access to the Service user interface. This requires a PIN to be entered. Refer to the Service Guide for information on the Settings screen.

## POWERING OFF THE MOVIEQUIET 26

If fully charged, the MovieQuiet 26 can be left for up to a week without turning it off.

1. Ensure unit has an SOC of more than 80% prior to powering unit off for storage.
2. Press and hold the button labelled OFF until the ON button light turns off (5 sec).
3. Release the button and move the main breaker to the OFF position.

# APPENDIX A - OPTIMAL OPERATING CONDITIONS



To maximize the life of the MovieQuiet 26, the following operating conditions are recommended:

1. Operate the MovieQuiet 26 between 0°C and 40°C whenever possible. The unit will continue to discharge if the battery is below 0°C and above -20°C but cannot be charged if the battery temperature is below 0°C. A battery heater option is available should operation below 0°C be expected.
2. When the battery is fully discharged and has automatically turned off, the MovieQuiet 26 output cannot operate until the battery has been sufficiently recharged. When the battery is fully discharged and has automatically turned off, recharge it as soon as possible. Even charging up to 5% state of charge (SOC) will prolong the battery life. Over-discharging the battery will shorten the battery life and may cause permanent damage.
3. If not used for more than 2 months, please discharge and recharge the battery. This helps prolong the battery life. Battery life may be shortened if the battery is always kept in a fully-charged state. For long-term storage, keep the battery at 40-60% SOC and discharge/charge every 1 or 2 months.
4. When the battery temperature is below 0°C, the battery performance may be affected and the lifespan may be shortened unless the battery warmer option has been purchased.
5. The battery should be kept under dry and ventilation conditions. Do not place the battery near fire or explosive products.
6. Do not wash the MovieQuiet 26 shell with organic solvent. In case of fire, do not use CO<sub>2</sub> to extinguish the fire. Instead, use CCl<sub>4</sub>, sand, or soil.
7. Please handle the MovieQuiet 26 with care. Avoid severe vibration, and do not drop.

# APPENDIX B - TYPICAL RUN TIMES



## MOVIEQUIET RUN TIMES (HOURS)

Manufacturer	Product	Power Consumption (max Watt)	MovieQuiet 6 6600 Wh	MovieQuiet 26 26400 Wh
<b>LED Lighting</b>				
ARRI	Skypanel 30	200	33	132
	Skypanel 60	450	14.7	58.7
	Skypanel 120	430	15.3	61.4
	Skypanel 360	160	4.13	16.5
CINEO	Lightblade	80	82.5	330
	Lightblade	160	41.3	165.0
	Edge 320	320	20.6	82.5
	LB800	900	7.3	29.3
	Standard 410	410	16.1	64.4
	HS2 Wave	500	13.2	52.8
	Maverick & Mav X	135	48.9	195.6
	Matchbox	13	507.7	2030.8
KINO	Celeb 250	150	44.0	176.0
	Celeb 450	250	26.4	105.6
	Celeb 850	500	13.2	52.8
	Freestyle 21/31/41	1000	6.6	26.4
<b>Tungsten Lighting</b>				
ARRI	300 Fresnel	300	22.0	88.0
	650 Fresnel	650	10.2	40.6
	1000 Fresnel	1000	6.6	26.4
<b>Ballast Lighting</b>				
ARRI	M8	800	8.3	33.0
	M18	1800	3.7	14.7
	M40	4000	1.7	6.6
	M90	9000		2.9